

How to wire up your Go-1 Network

Contents:

- 1) Go-1 UI Module
 - a) Power
 - b) Network
- 2) Go-A Module
 - a) Power
 - b) Network
 - c) Sensors
- 3) Common Sense 2 Controller
- 4) Original Common Sense Controller
- 5) Boomerang

Greenhouse Technology Inc.

1-A) Go-1 User Interface Module - Power Wire

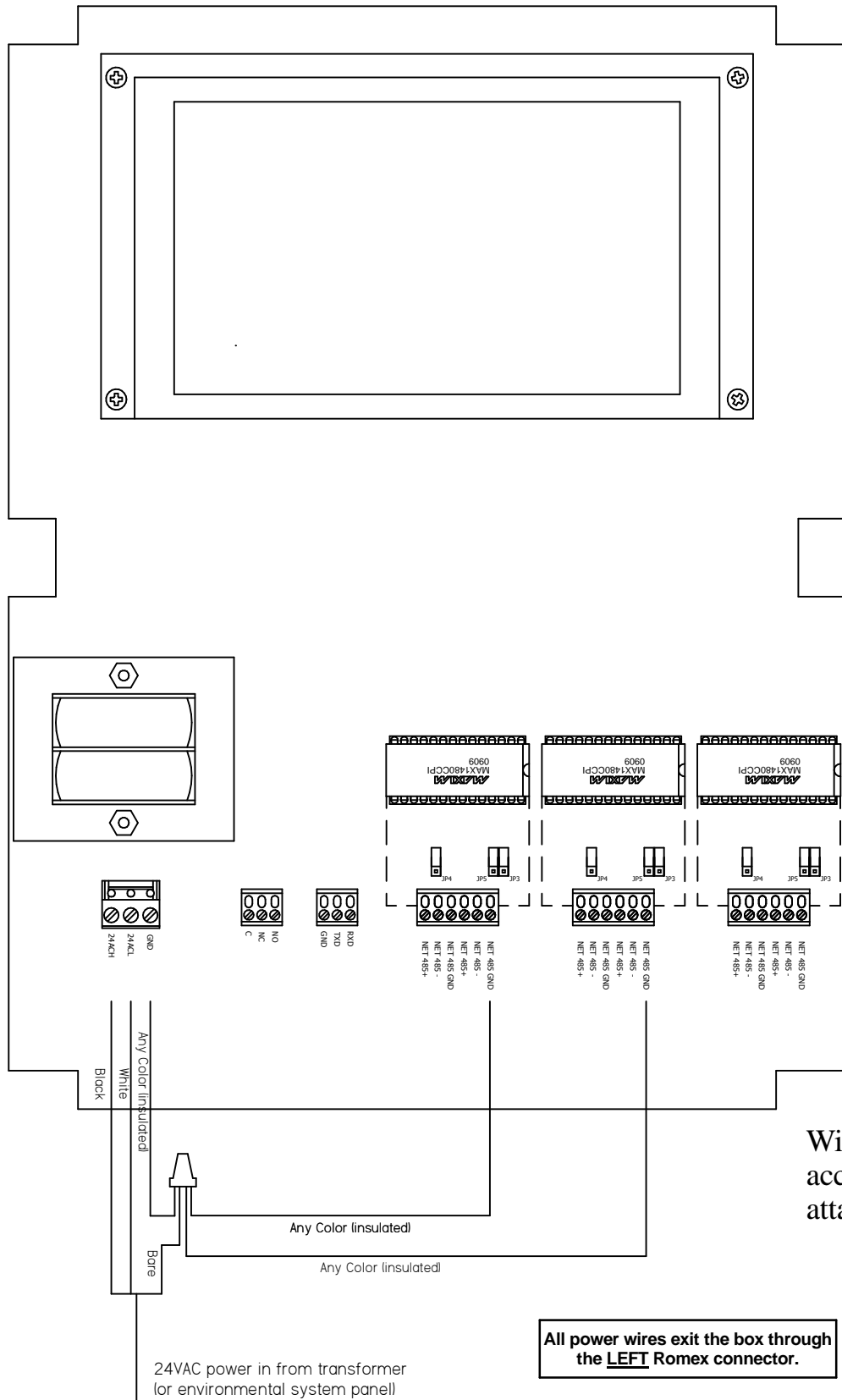

1-B) Go-1 User Interface - Network Wire

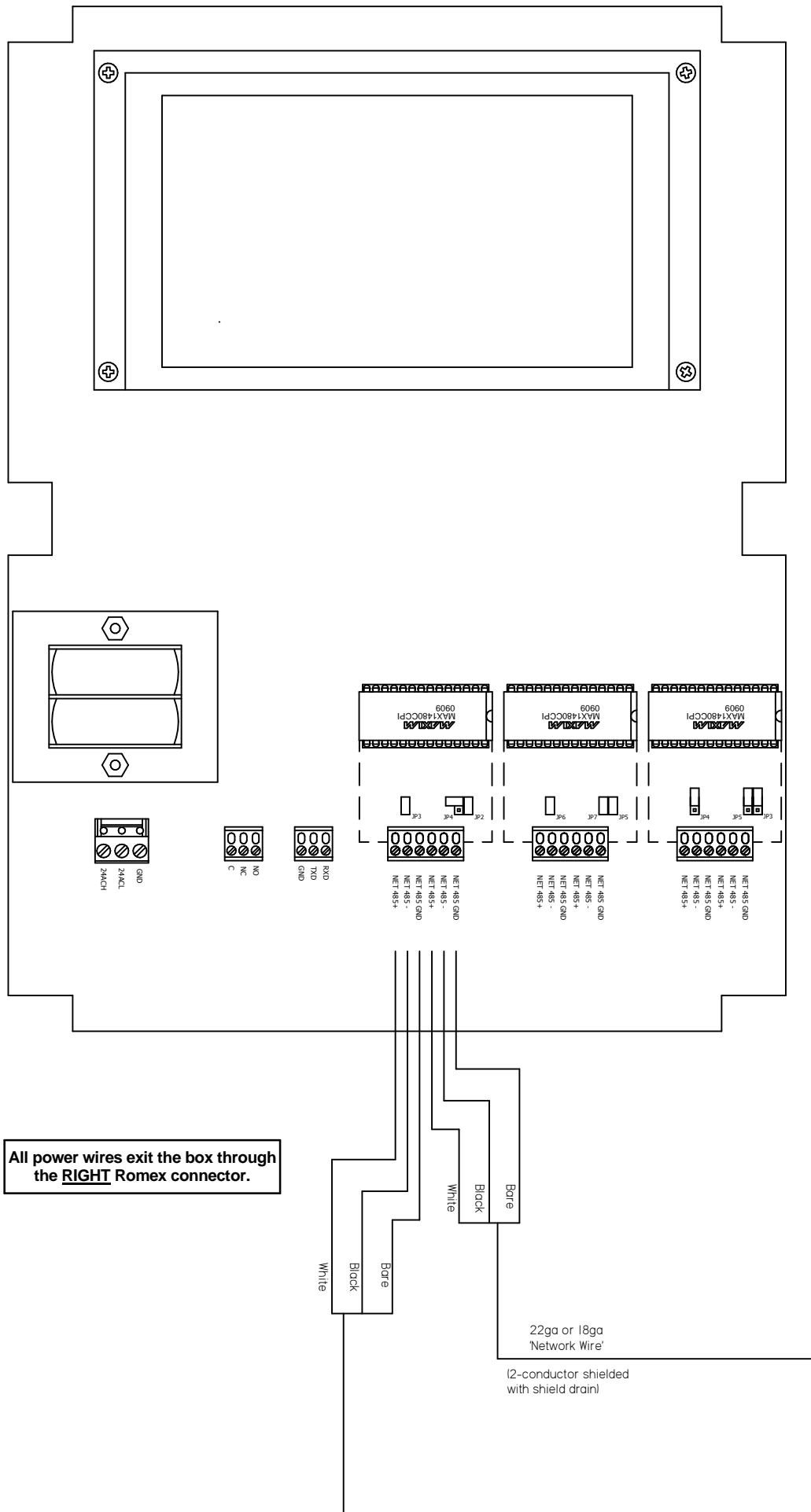

Set Network Jumpers
- Go-1 UI

Bias:

- JP2 - On
- JP3 - On
- JP5 - On
- JP6 - On

Termination:

- JP4 - Off (horizontal)
- JP7 - Off (horizontal)

2-A) Go-A - Network Wire

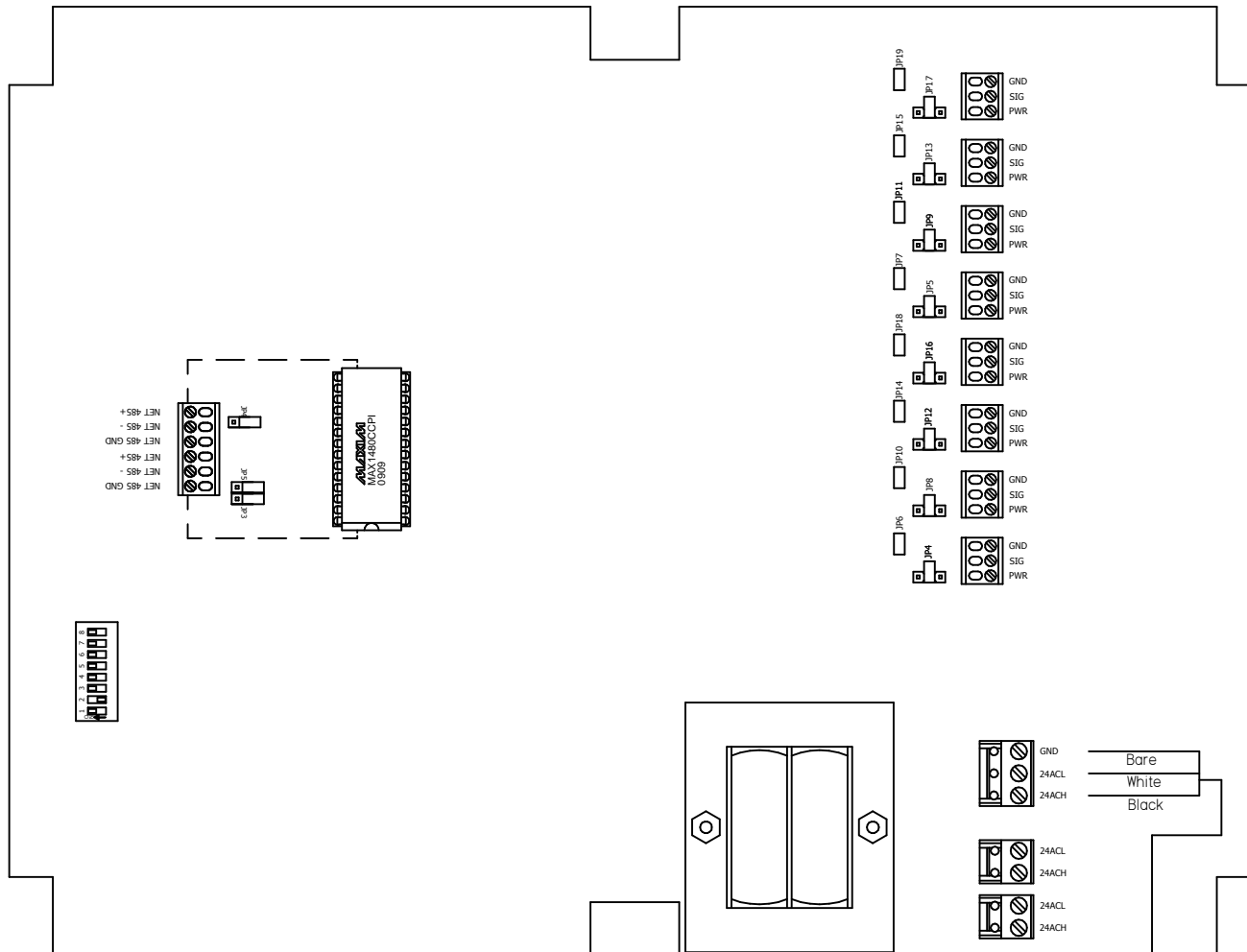

If the Jumper wire from the Go-1 is too long, use a separate transformer / run power from an environmental system sub-panel.

Increase F3 size from:

250V 500mA
to
250V 1A

All power wires exit the box through the RIGHT Romex connector.

2-B) Go-A - Network - Wiring

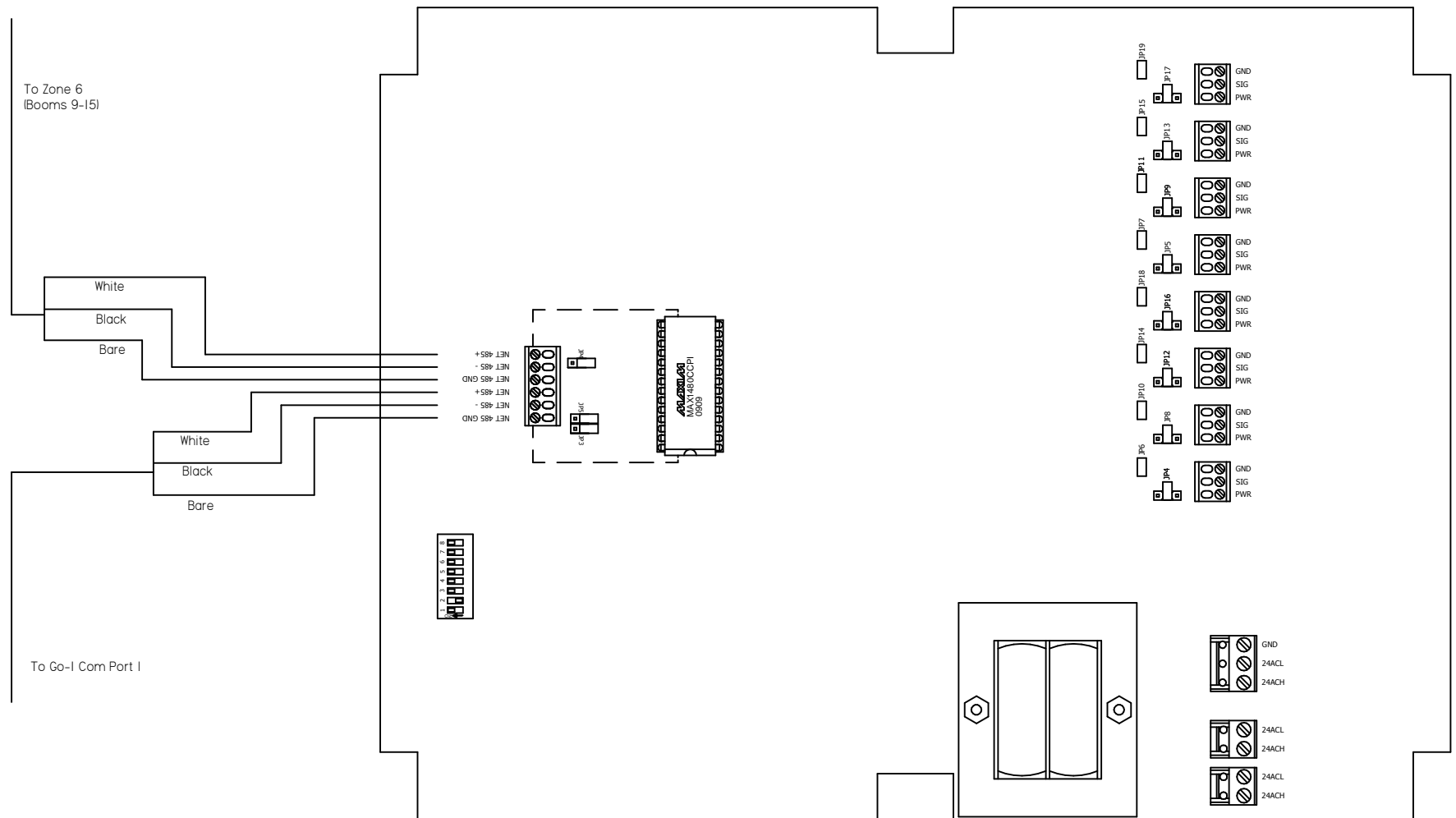

Set Jumpers for Zone 5 Sensor Module:

- JP4 - Middle pin only
- JP6 - Both Pins
- JP8 - Middle pin only
- JP10 - Both Pins
- JP12 - Middle and +5 pins
- JP14 - one pin only (horizontal)

2-C) Go-A - Zone 5 Sensor Module - Wiring

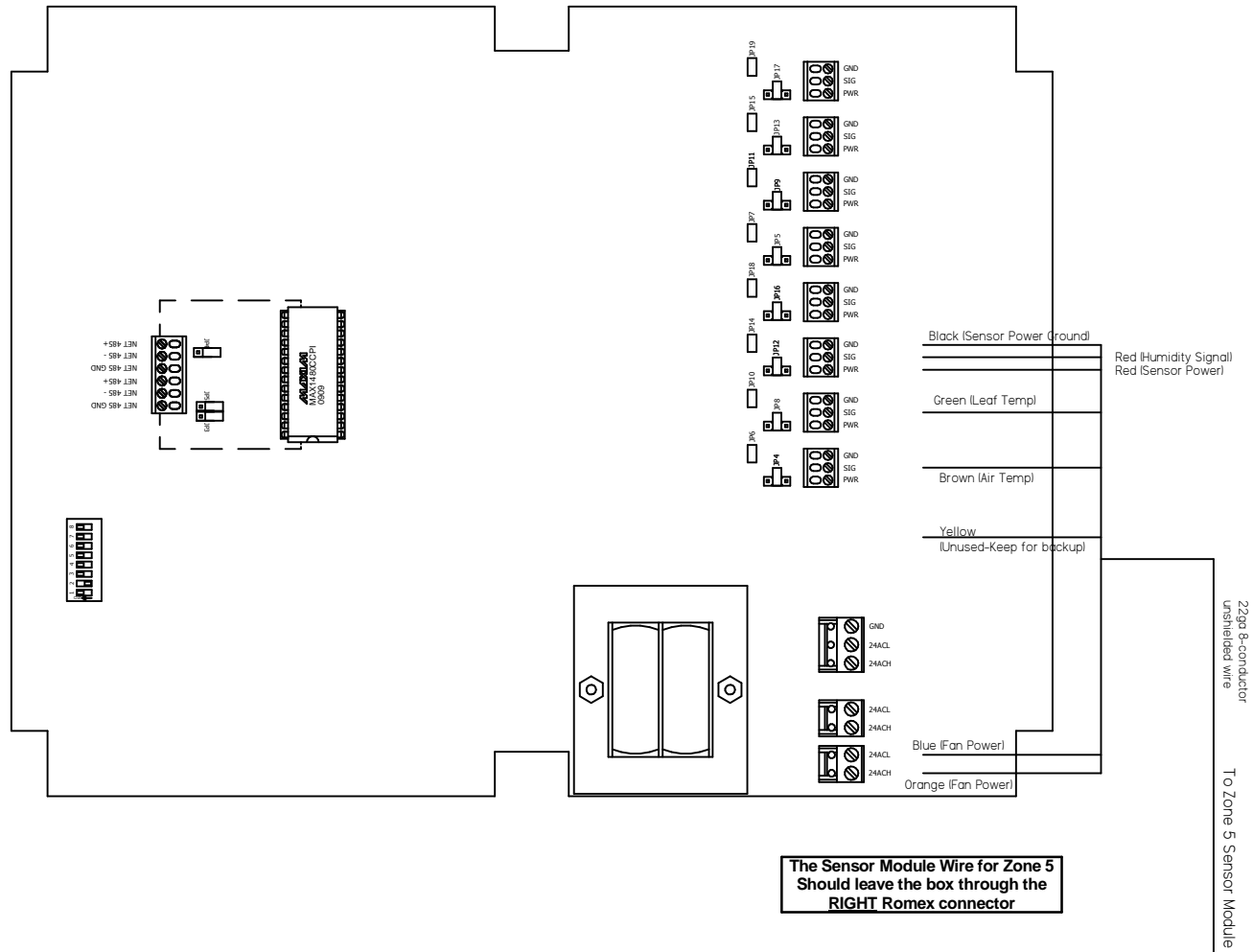

Set Jumpers for Zone 5 Sensor Module:

JP4 - Middle pin only

JP6 - Both Pins

JP8 - Middle pin only

JP10 - Both Pins

JP12 - Middle and +5 pins

JP14 - one pin only (horizontal)

2-C) Go-A - Zone 6 Sensor Module - Wiring

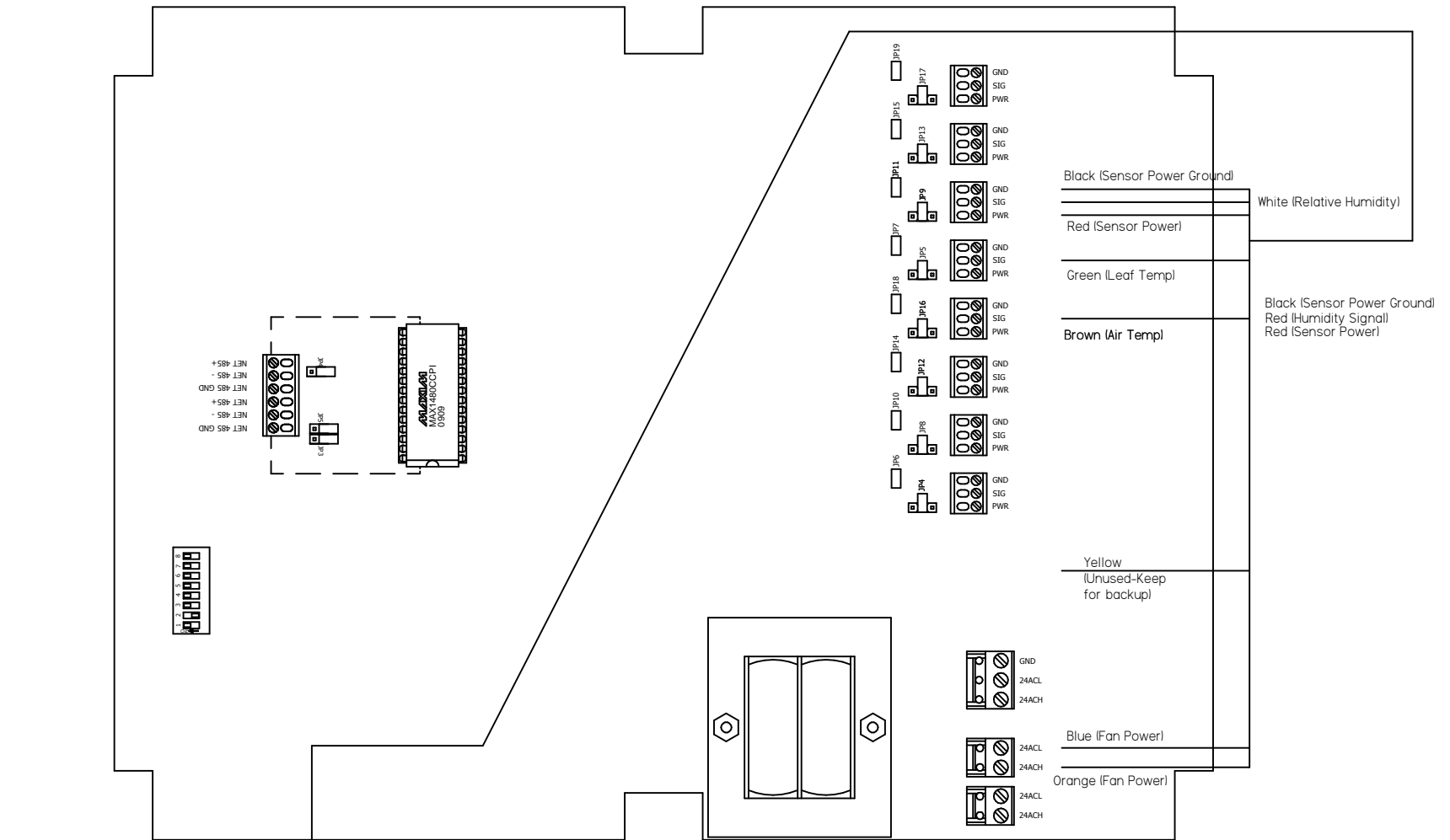

The Sensor Module Wire for Zone 6
Should leave the box through the
LEFT Romex connector

Set Jumpers for Zone 6 Sensor Module:

- JP16 - Middle pin only
- JP18 - Both Pins
- JP5 - Middle pin only
- JP7 - Both Pins
- JP9 - Middle and +5 pins
- JP11 - one pin only (horizontal)

2-A) Common Sense 2 Main Board - Network Wiring

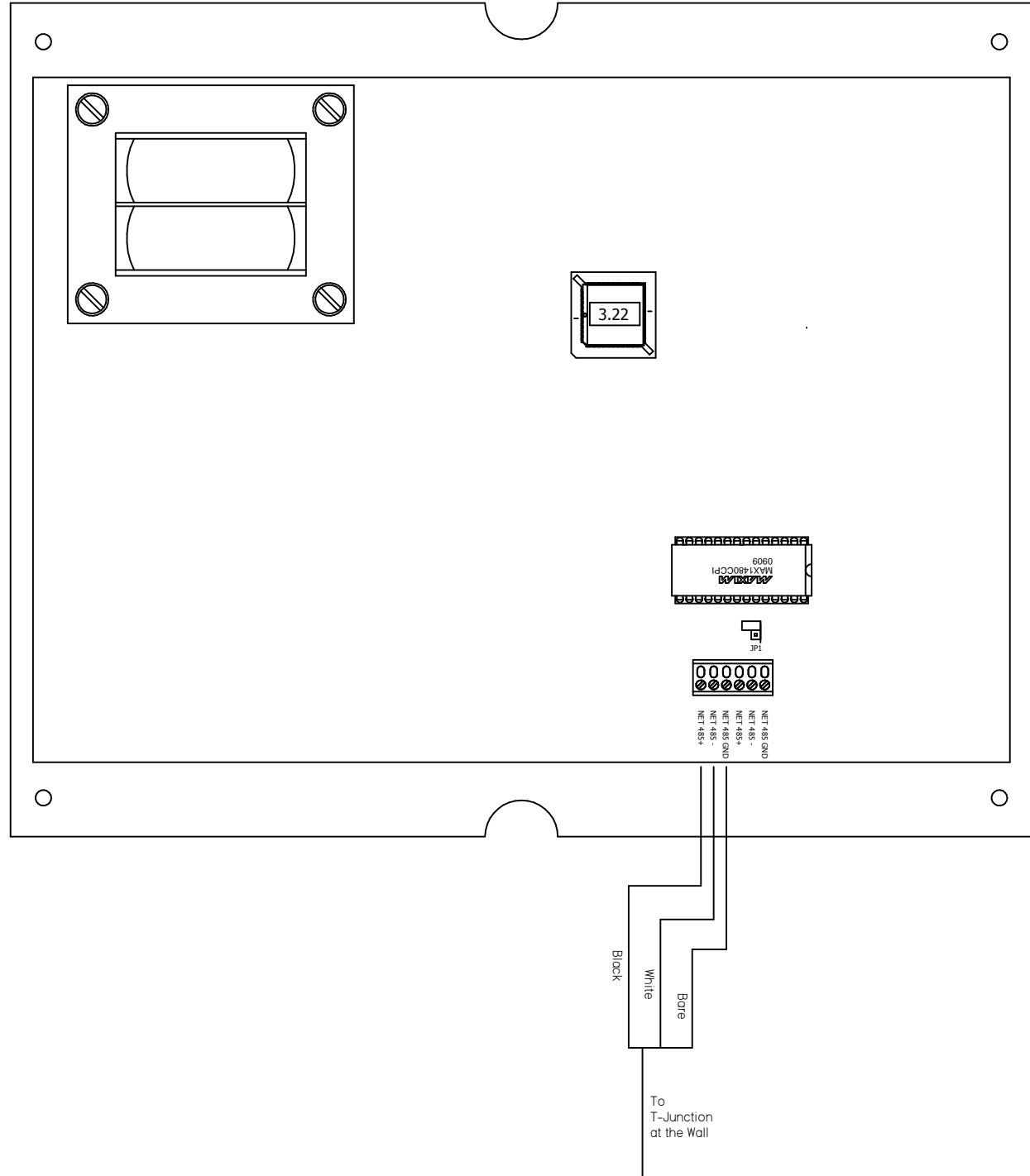

Set Network Jumper

JP1:

On - Booms 1 & 16

Off - Booms 2-15

Boom Addresses

(Set in Go-1 First, then in each boom)

Boom 1 - Address 03

Boom 2 - Address 04

.....

Boom 15 - Address 17

2-A) Common Sense Main Board - Network Wiring

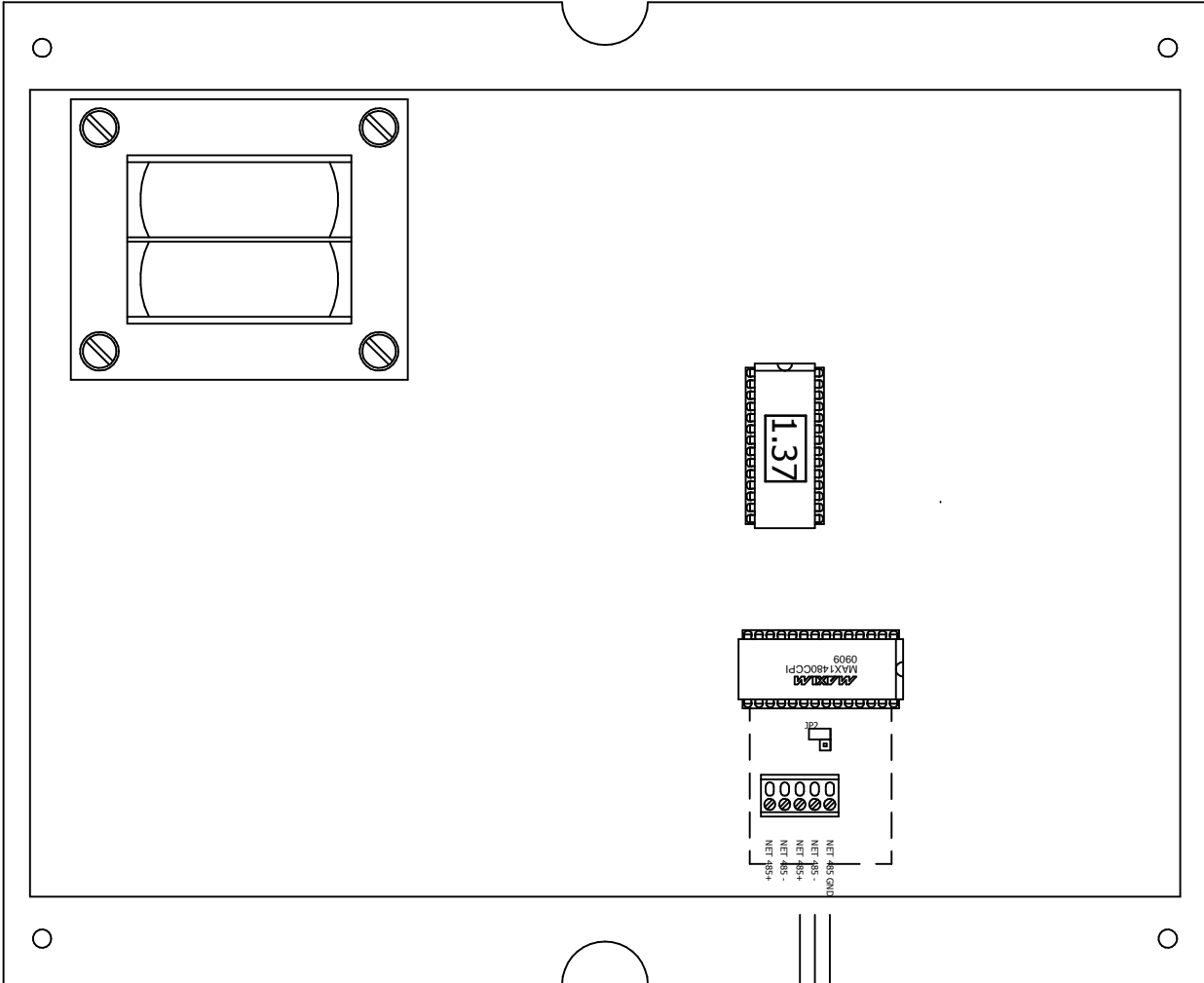

Set Network Jumper

JP2:

- On - Booms 1 & 16
- Off - Booms 2-15

Boom Addresses

(Set in Go-1 First, then in each boom)

- Boom 1 - Address 03
- Boom 2 - Address 04
-
- Boom 15 - Address 17

2-A) Boomerang Board - Network Wiring

Set Network Jumpers

All Boomerangs:

JP3, JP4 off

Boomerangs at the end-of-line:

JP5 on

All other Boomerangs:

JP5 off

Boomerang Addresses

(Put Boomerangs on Com Port 2)

(Power down Boomerang, change
dipswitches, power Boomerang back up)

Boomerang 01 - Address 02 10000

Boomerang 02 - Address 03 01000

Boomerang 03 - Address 04 11000

Boomerang 04 - Address 04 00100

...

10100, 01100, 11100, 00010, 10010, 01010,

11010, 00110, 10110, 01110, 11110, 00001,

10001, 01001, 11001, 00101, 10101, 01101,

11101, 00011, 10011, 01011, 11011, 00111,

10111, 01111, 11111

